

## AV-60 Bronze Plug Cock - Main Cock (Flanged Ends)

### Features

Flanged Ends to BS-10 Table 'D'  
With a Rotary Taper Plug, Taper Seated Body

### Test Pressure

Body : 300 Psig (Hyd.)  
Seat (Plug) : 150 Psig (Hyd.)

### Testing Standard

BS EN 12266 Part-1

### Suitability

Water, Oil



### Material Combination

P.No.	Name of Part	Material	Specification
1	Plug	Bronze	BS 1400 LG2
2	Body	Bronze	BS 1400 LG2
3	Washer	Bronze	BS 1400 LG2
4	Spring Washer	Spring Steel	-
5	Nut	M.S.	BS 916

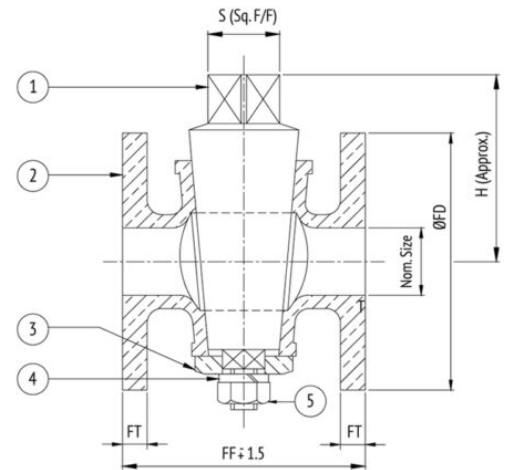

### Dimensional Data

Nominal Size (mm)	FF	H	S	ØFD	FT
15	58	75	13	95.3	6.4
20	60	75	17	101.6	6.4
25	77	84	18	114.3	7.9
32	84	92	23	120.7	7.9
40	97	95	25	133.4	9.5
50	108	105	27	152.4	9.5
65	163	155	32	165.1	11.1
80	189	184	33	184.2	12.7
100	259	165	48	215.9	15.9